

Belastningklasse 5 (450 kg/m²)

SPIR VERTIKAL

stål

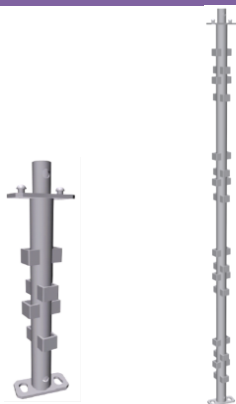

Høyde (m)	Vekt	Art. nr.
3,00	19,3 kg	RNS-04011
2,00	13,1 kg	RNS-04012
1,50	10,1 kg	RNS-04013
1,00	7,0 kg	RNS-04014
0,50	4,1 kg	RNS-04015

LENGDEBJELKE, LB

stål



Lengde (m)	Vekt	Art. nr.
3,00	18,5 kg	RNS-02300
2,45	15,6 kg	RNS-02245
1,90	11,6 kg	RNS-02190
1,60	9,3 kg	RNS-02161

TVERRBJELKE, TB

stål



Lengde (m)	Vekt	Art. nr.
1,60	7,3 kg	RNS-02160
1,20	5,6 kg	RNS-02120
1,00	5,0 kg	RNS-02100
0,70	3,9 kg	RNS-02070
0,50	2,9 kg	RNS-02050
0,30	2,1 kg	RNS-02030

ENRØRSBJELKE, EB

stål



Lengde (m)	Vekt	Art. nr.
3,00	14,9 kg	RNS-02008
2,45	12,3 kg	RNS-02007
1,90	10,1 kg	RNS-02006
1,60	7,9 kg	RNS-02005
1,20	7,0 kg	RNS-02004
1,00	5,5 kg	RNS-02003
0,70	5,0 kg	RNS-02002
0,50	4,1 kg	RNS-02001

ENRØRSBJELKE HØY

stål



Lengde (m)	Vekt	Art. nr.
1,20	7,5 kg	RNS-02014
1,60	8,4 kg	RNS-02015

Delta System AS

Kirkesvingen 2, 3180 Nykirke

Tlf.: +47 41 38 66 63

Tlf.: +47 41 39 66 60

Tlf.: +47 48 40 16 60

www.deltasystem-olan.no
post@deltasystem-olan.no

REKKVERK

stål

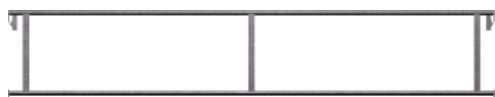

Lengde (m)	Vekt	Art. nr
3,00	13,1 kg	RNS-03300
2,45	12,1 kg	RNS-03245
1,90	10,0 kg	RNS-03190
1,60	9,7 kg	RNS-03160
1,20	5,9 kg	RNS-03120

REKKVERK

aluminium

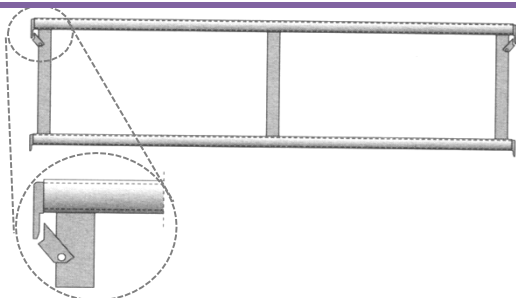

Lengde (m)	Vekt	Art. nr
3,00	9,8 kg	RNA-11300[S1]
2,45	8,3 kg	RNA-11245[S1]
1,90	6,8 kg	RNA-11190
1,60	5,6 kg	RNA-11160
1,20	4,2 kg	RNA-11120

PLANK 17 cm

aluminium, kl. 5

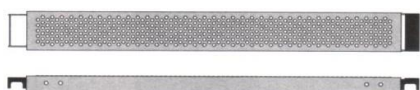

Lengde (m)	Vekt	Art. nr
3,05	10,9 kg	RNA-06305A
2,50	8,5 kg	RNA-06250A
1,96	6,9 kg	RNA-06196A
1,65	5,9 kg	RNA-06165A
1,25	4,9 kg	RNA-06125A
1,05	4,4 kg	RNA-06105A
0,77	2,4 kg	RNA-06077A
0,55	1,8 kg	RNA-06055A

PLANK 23 cm

aluminium, kl. 5

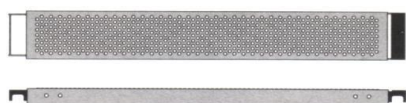

Lengde (m)	Vekt	Art. nr
3,05	11,3 kg	RNA-05305A
2,50	9,4 kg	RNA-05250A
1,96	8,5 kg	RNA-05196A
1,65	7,4 kg	RNA-05165A
1,25	6,0 kg	RNA-05125A
1,05	5,5 kg	RNA-05105A
0,77	4,6 kg	RNA-05077A
0,55	3,2 kg	RNA-05055A

PLANK 23 cm

stål, kl. 5

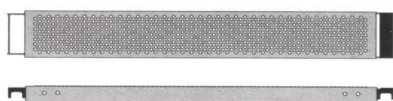

Lengde (m)	Vekt	Art. nr
3,05	22,8 kg	RNS-08305
1,25	9,6 kg	RNS-08125

Delta System AS

Kirkesvingen 2, 3180 Nykirke

Tlf.: +47 41 38 66 63

Tlf.: +47 41 39 66 60

Tlf.: +47 48 40 16 60

www.deltasystem-olan.no
post@deltasystem-olan.no

DIAGONALSTAG, DSLB

stål



3,00	14,6 kg	RNS-05300
2,45	12,8 kg	RNS-05245
1,90	10,7 kg	RNS-05190
1,60	9,9 kg	RNS-05160
1,20	8,4 kg	RNS-05120

DIAGONALSTAG TELESKOP, DST

aluminium



3,60	9,5 kg	RNA-01360
------	--------	-----------

ALUMINIUM LABANK KI.5

alu

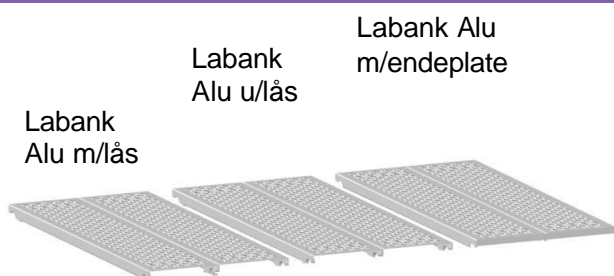

ALU LABANK 1,2 x 0,6m MED LÅS	9,1 kg	RNA-16595/2,5
ALU LABANK 1,25X0,6 UTEN LÅS	9,1 kg	RNA-16595/2,5
ALU LABANK 1,25X0,5 M/ENDEPLATE	7,9 kg	RNA-16495/2,5

LUKEPLATTING

aluminium

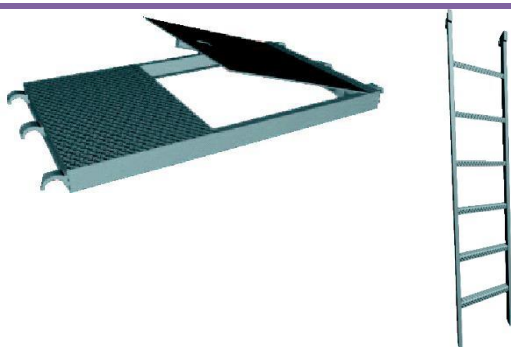

1,20	17,5 kg	RNA-00712
2,10	3,6 kg	RNA-00214

Delta System AS

Kirkesvingen 2, 3180 Nykirke

Tlf.: +47 41 38 66 63

Tlf.: +47 41 39 66 60

Tlf.: +47 48 40 16 60

www.deltasystem-olan.no
post@deltasystem-olan.no

BUNNSKRUER

stål

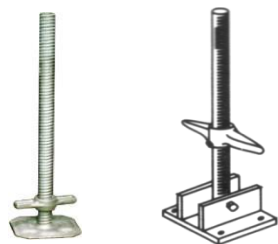

32x800	5,5 kg	RFS-12080/32
38x600	4,0 kg	RFS-12060
Bunnskrue leddet 38x600	5,3 kg	RFS-12260

FOTLIST + FESTE + SKJØT

aluminium



Fotlist feste (FLF)

Fotlist skjøt (FLS)

3,00	6,5 kg	RNA-07030
2,45	5,4 kg	RNA-07025
1,90	4,1 kg	RNA-070190
1,60	3,5 kg	RNA-07016
1,20	2,7 kg	RNA-07012
1,00	2,2 kg	RNA-07010
0,70	1,7 kg	RNA-07007
FLF	0,7 kg	RNA-07000
FLS	0,2 kg	RNA-07000.1

VEGGFESTE, STAG, KLEMME, ØYEBOLT

stål

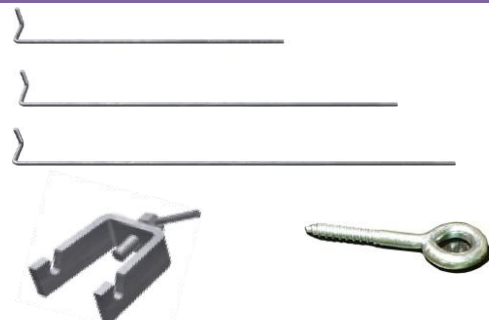

0,60	0,7 kg	RNA-17060
1,20	1,2 kg	RNA-17120
Klemme	0,6 kg	RNA-17000
Øyebolt	0,0 kg	

VEGGFESTE (RØR + KLIPS FAST)

stål



0,40	1,7 kg	RFS-17040
0,85	4,0 kg	RFS-17085
1,10	4,2 kg	RFS-17110
1,30	4,5 kg	RFS-17130
Klips fast	1,3 kg	ZNN-ZB02

Delta System AS

Kirkesvingen 2, 3180 Nykirke

Tlf.: +47 41 38 66 63

Tlf.: +47 41 39 66 60

Tlf.: +47 48 40 16 60

www.deltasystem-olan.no
post@deltasystem-olan.no

KONSOLL

stål

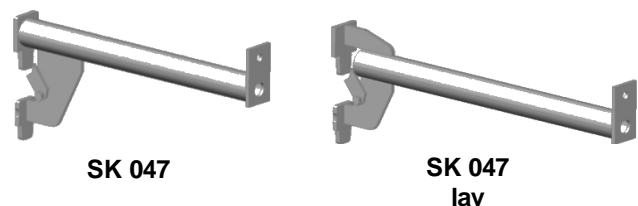

0,30	2,3 kg	RNS-06008
0,47	3,5 kg	RNS-06006
lav 0,47	3,0 kg	RNS-06009
0,50	6,3 kg	RNS-06004
0,70	7,5 kg	RNS-06005

KONSOLL

stål

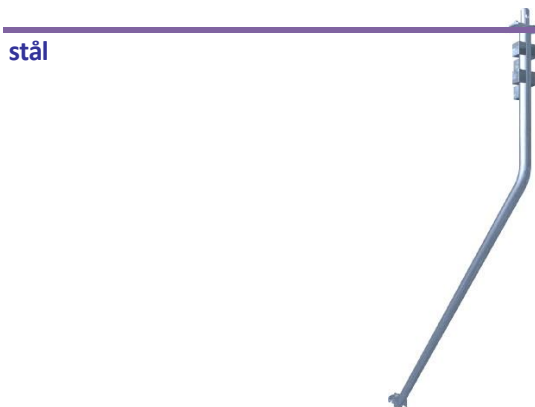

1,20	12,3 kg	RNS-06003
------	---------	-----------

JUSTERBAR KONSOLL

stål

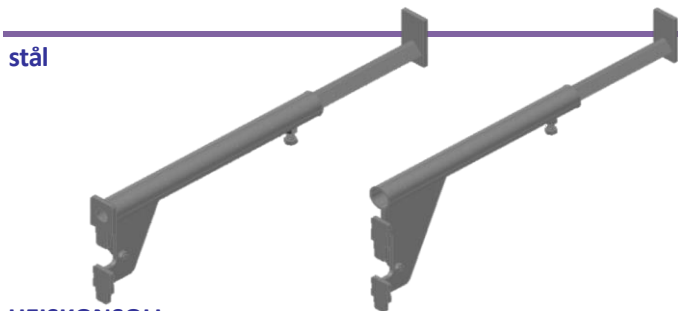

Benevnelse	Vekt	Art. nr.
2-3 Plank (Høy)	6,7 kg	RNS-06001
2-3 Plank (Lav)	5,4 kg	RNS-06002

HEISKONSOLL

stål

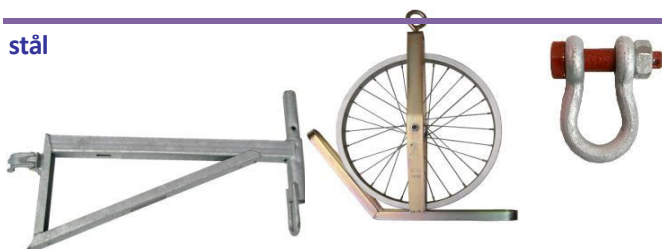

Benevnelse	Vekt	Art. nr.
Heiskonsoll	8,0 kg	RFS-25080
Hjul	2,7 kg	RFS-2001
Sjakkell	0,4 kg	
Hårnålssplinter	0,0 kg	ZNN-00001

Delta System AS

Kirkesvingen 2, 3180 Nykirke

Tlf.: +47 41 38 66 63

Tlf.: +47 41 39 66 60

Tlf.: +47 48 40 16 60

www.deltasystem-olan.no
post@deltasystem-olan.no

DRAGER

aluminium

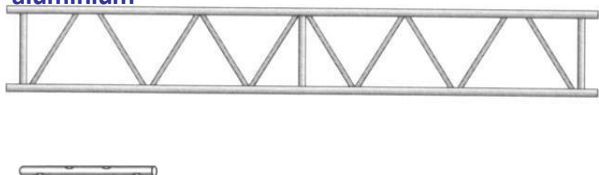

Length (m)	Weight (kg)	Part No.
8,24	34,4 kg	RFA-05824
6,24	26,4 kg	RFA-05624
5,24	22,6 kg	RFA-05524
4,24	18,8 kg	RFA-05424
Skjøtestuss	2,2 kg	RFA-05000

DRAGER ENDE

stål

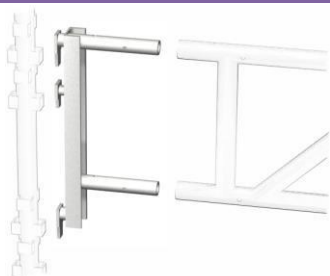

Part Name	Weight (kg)	Part No.
Drager ende	6,9 kg	RNS-00004

BJELKERYTTER

stål

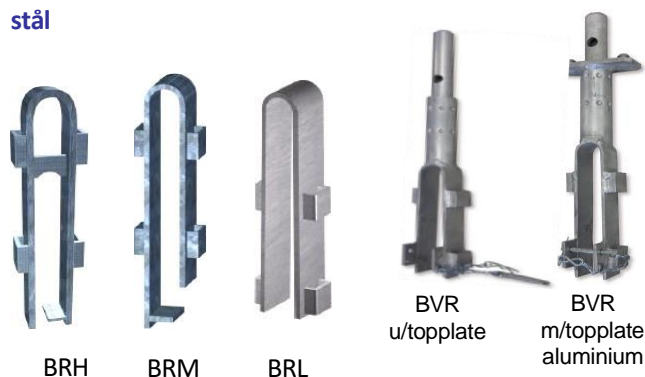

Part Name	Weight (kg)	Part No.
BRH	2,9 kg	RNS-47310
BRM	2,6 kg	RNS-47320
BRL	2,8 kg	RNS-37330
BVR u/topplate	1,3 kg	RNA-47320
BVR m/topplate	1,4 kg	RNA-47321

VANGELÅS

stål



Part Name	Weight (kg)	Part No.
Vangelås	0,1 kg	RNS-03000.1

PLANKERYTTERE

aluminium

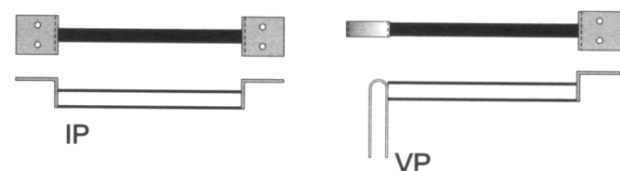

Part Name	Weight (kg)	Part No.
IP 0,70	1,8 kg	RNA-12070
IP 0,47	1,5 kg	RNA-12047
IP 0,23	1,2 kg	RNA-12002
VP 0,70	1,8 kg	RNA-13070
VP 0,47	1,5 kg	RNA-13047
VP 0,23	1,2 kg	RNA-13023

Delta System AS

Kirkesvingen 2, 3180 Nykirke

Tlf.: +47 41 38 66 63

Tlf.: +47 41 39 66 60

Tlf.: +47 48 40 16 60

www.deltasystem-olan.no
post@deltasystem-olan.no

STIGE

aluminium



LE 2,35

2,35

9,8 kg

RNA-00235

TRAPP

aluminium

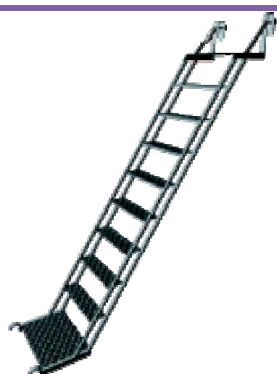

2,00x1,96

15,0 kg

RNA-00000

2,00x1,60

14,2 kg

RNA-00001

2,00x1,20

13,0 kg

RNA-00002

2,20x1,20

15,0 kg

RNA-00003

TRAPPETÅRN TRAPP

stål og aluminium



stål 1,60x2,00

43,8 kg

RNS-01200

stål 1,60x1,50

34,0 kg

RNS-01150

alu 1,60x2,00

20,5 kg

RNA-00005

alu 1,60x1,50

15,4 kg

RNA-00004

INNSTEGSTRINN FOR TRAPPETÅRN

stål



1,60

15,0 kg

RNS-00002

TRAPPETÅRN REPOS

stål



2,00x0,65

23,5 kg

RNS-00001

Delta System AS

Kirkesvingen 2, 3180 Nykirke

Tlf.: +47 41 38 66 63

Tlf.: +47 41 39 66 60

Tlf.: +47 48 40 16 60

www.deltasystem-olan.no
post@deltasystem-olan.no

TRAPPETÅRN GELENDER

stål



1,60x2,00

10,3 kg

RNS-03001

1,60x1,50

9,0 kg

RNS-03002

TRAPPETÅRN GELENDERSTOLPE

stål

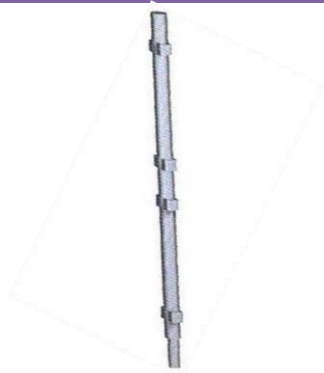

1,00

7,0 kg

RNS-04002

TRAPPETÅRN FOLDE REKKVERK

stål

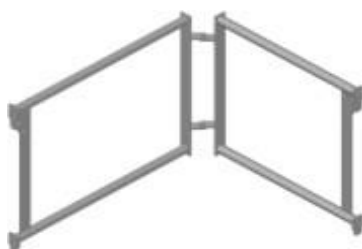

Folderekkverk

9,4 kg

RNS-03003

TOPP REKKVERK

stål



1,00

7,7 kg

RNS-04003

Delta System AS

Kirkesvingen 2, 3180 Nykirke

Tlf.: +47 41 38 66 63

Tlf.: +47 41 39 66 60

Tlf.: +47 48 40 16 60

www.deltasystem-olan.no
post@deltasystem-olan.no

DOBBELT REKKVERK

aluminium



Lengde (m)	Vekt	Art. nr.
2,30	7,9 kg	RNA-11230

REKKVERK STOLPE

stål



Benevnelse	Vekt	Art. nr.
Rekkverk stolpe	5,8 kg	RNS-04001

(clip on post)

TAKBØYLE med forlengelse

stål

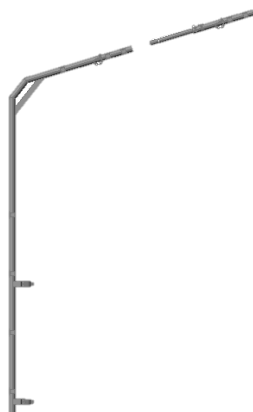

Benevnelse	Vekt	Art. nr.
Takbøyle m/ forlengelse.		RNS-04740

LAGERTAINER

stål

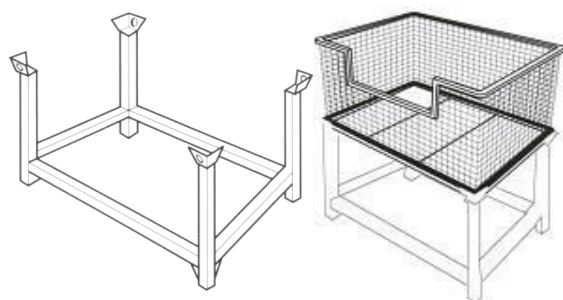

Lengde x Bredder (m)	Vekt	Art. nr.
1,20x0,80	26,8 kg	RFS-61280
Forsterket 1,20x0,80	58 kg	RFS-61281
Korg 1,08x0,68	30,4 kg	RFS-60567

Delta System AS

Kirkesvingen 2, 3180 Nykirke

Tlf.: +47 41 38 66 63

Tlf.: +47 41 39 66 60

Tlf.: +47 48 40 16 60

www.deltasystem-olan.no
post@deltasystem-olan.no